

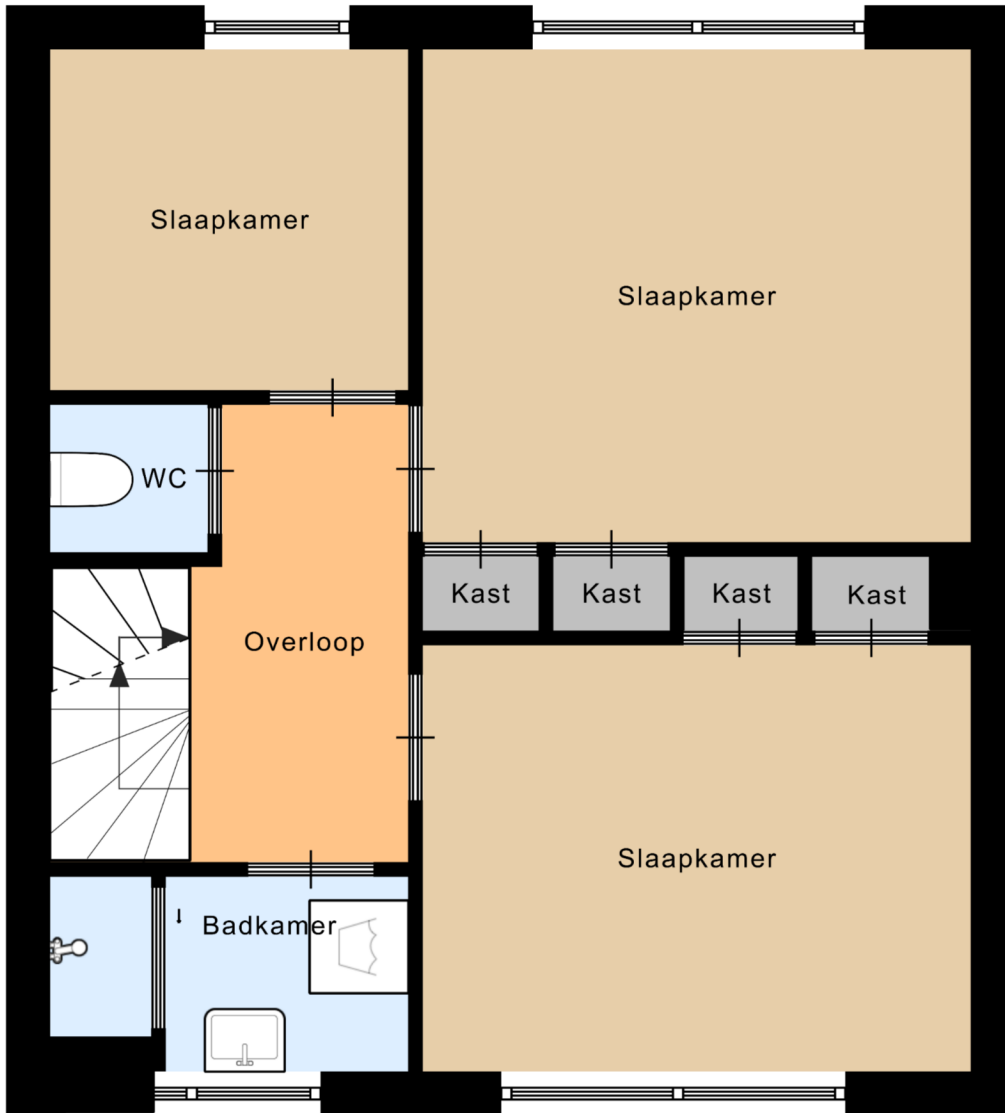

Begane Grond

2.43 m 3.72 m



2.31 m  
1.00 m  
2.00 m  
1.32 m

3.34 m  
0.50 m  
2.89 m

6.93 m

0.68 m 1.65 m 3.72 m

6.20 m

# 1e Verdieping

2.43 m 3.67 m

6.93 m  
3.50 m  
1.62 m  
1.61 m

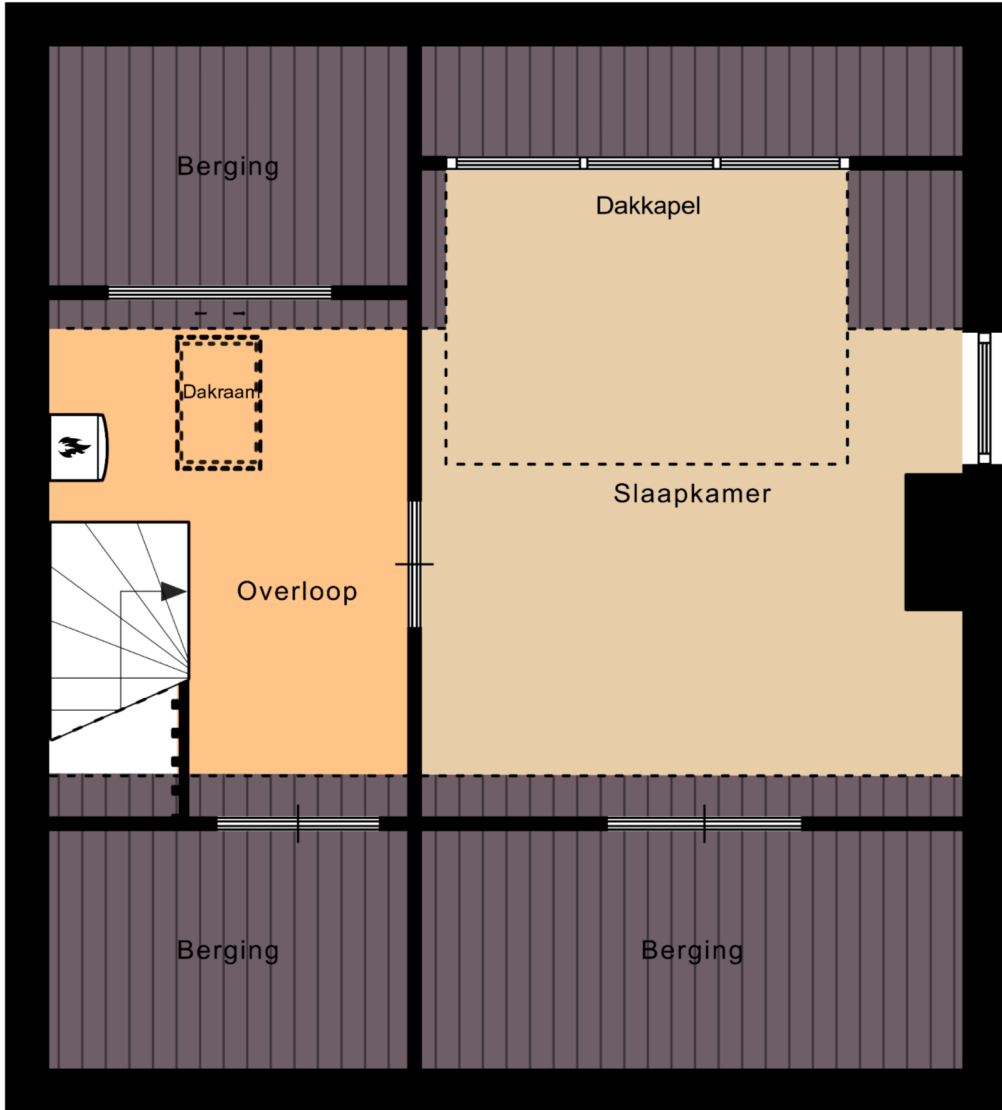

0.74 m  
4.38 m  
1.61 m

2.43 m 3.67 m

6.20 m

## 2e Verdieping

6.50 m

2.71 m

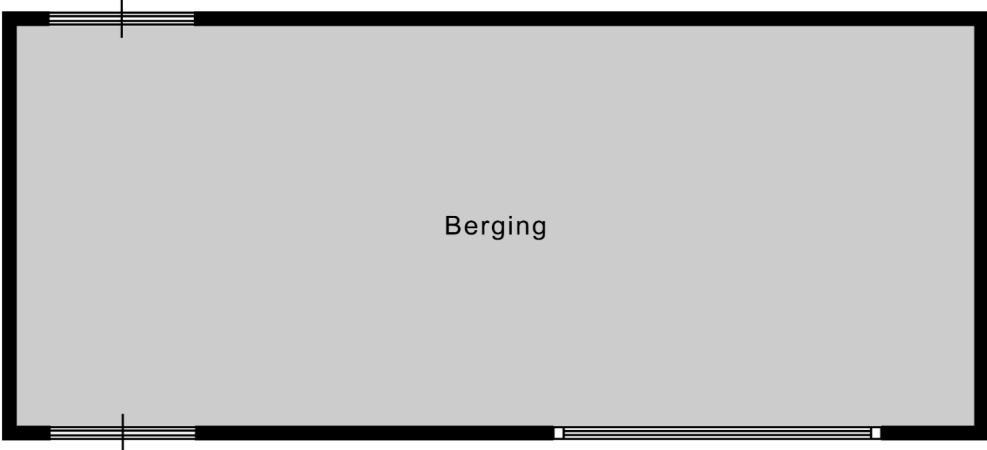

2.71 m

6.50 m

Berging